

Laboratory and Field Evaluation of the 24th Street Bridge

Terry Wipf, Iowa State University
Brent Phares, Iowa State University
Travis Hosteng, Iowa State University
Jake Bigelow, Iowa State University

August 20, 2009



24th Street Bridge Background

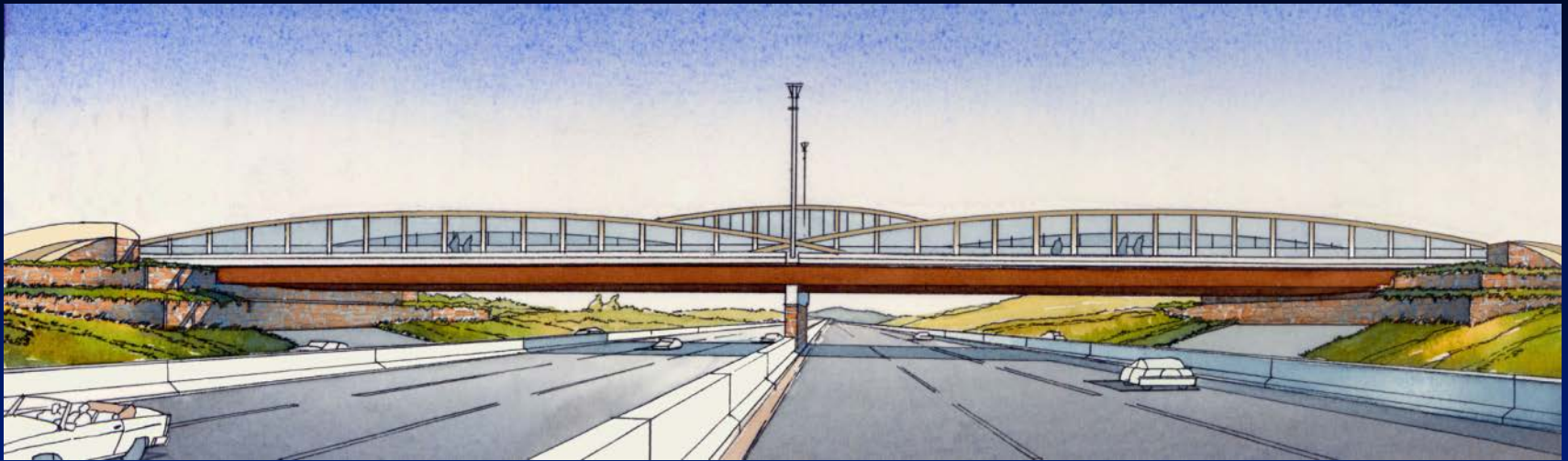

- Council Bluffs, Iowa
- Over Interstate 80/29
- Constructed in two phases
- Opened in Spring of 2009

Objectives

- Document the effectiveness of innovative construction techniques
 - Laboratory component
 - » Answer design and construction questions
 - Field component
 - » Evaluation during and after construction



Bridge Description

- Two spans
- 353.5 ft long
- 6 lanes plus sidewalks (99 ft wide)
- Precast deck panels (post tensioned)
- Composite steel girders





Bridge Plan/ Girder Layout

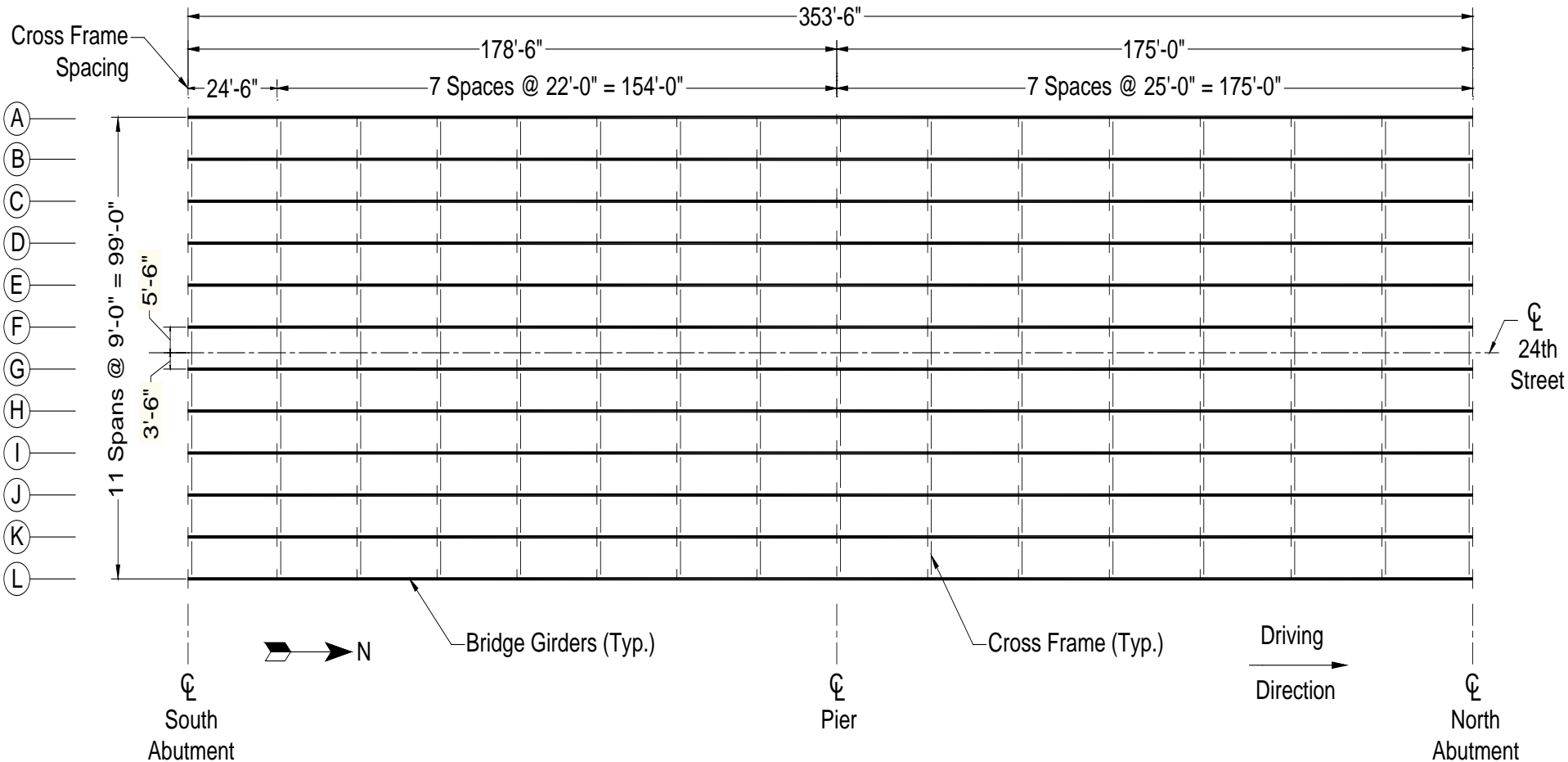



Precast Panel Plan

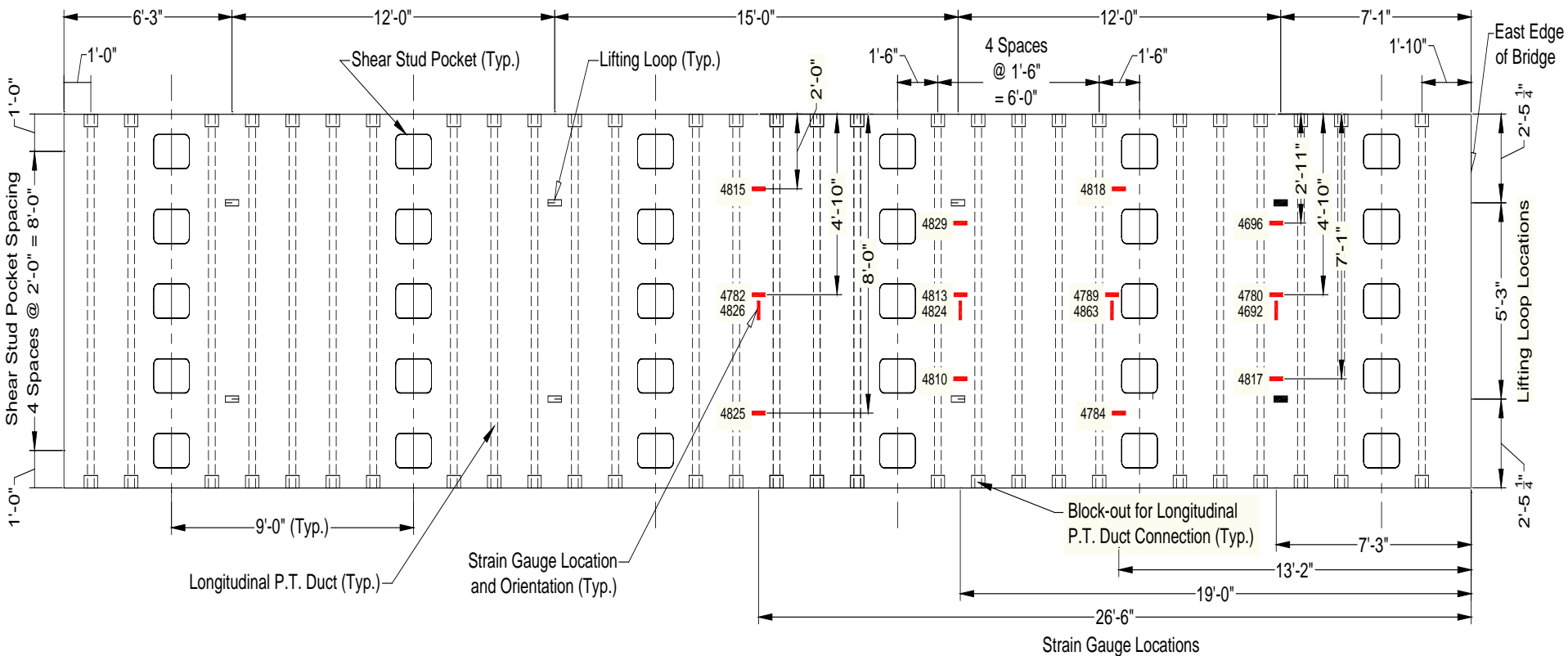

Precast Panel





Bridge Plan/ Panel Layout

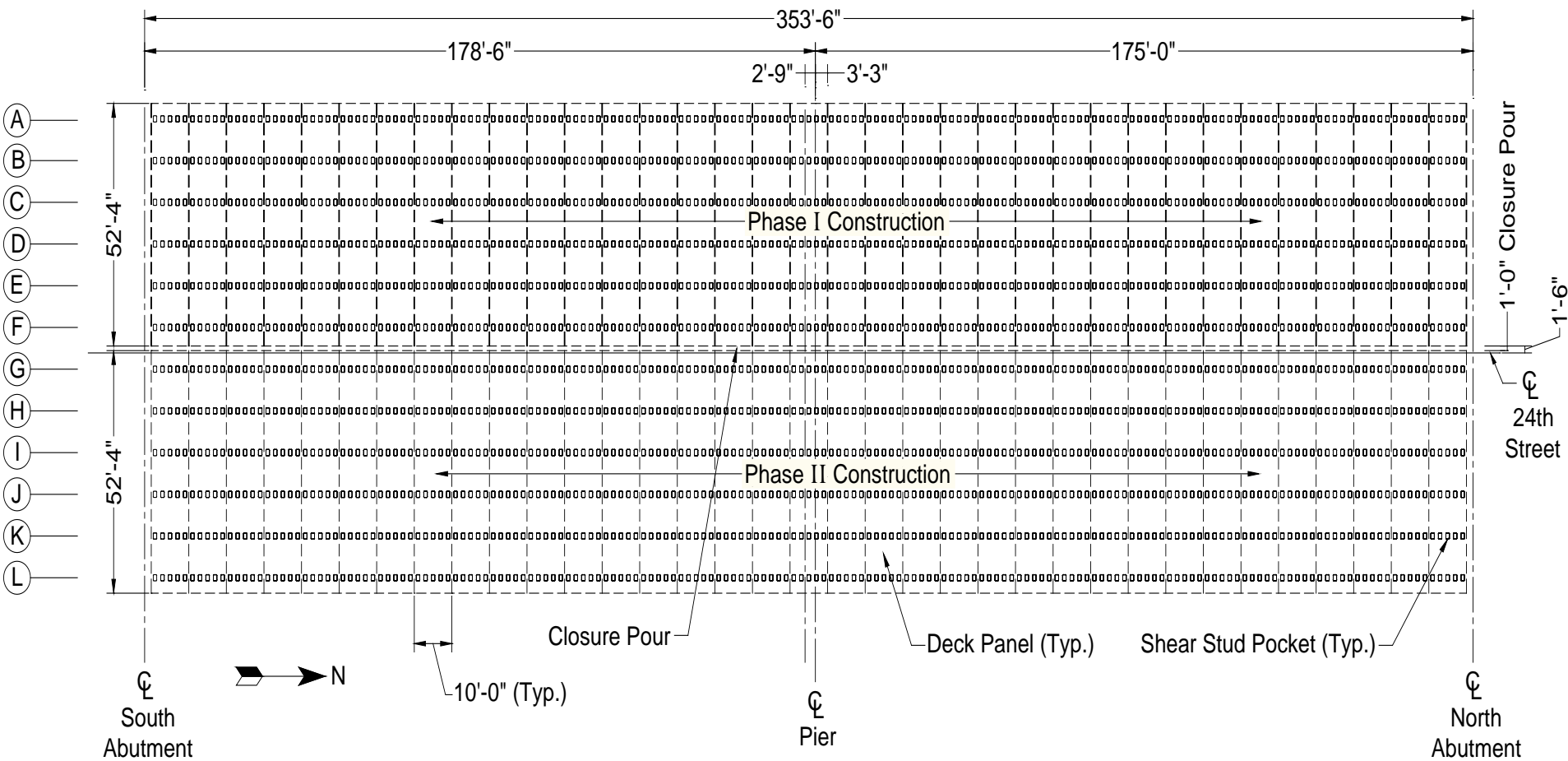

Bridge / Panel Layout



Laboratory Testing

- Stud pocket bend test
 - Confined space in pocket
 - Able to conduct bend test on all studs

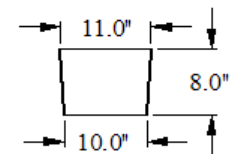
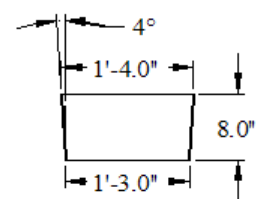

Cross-Section Views

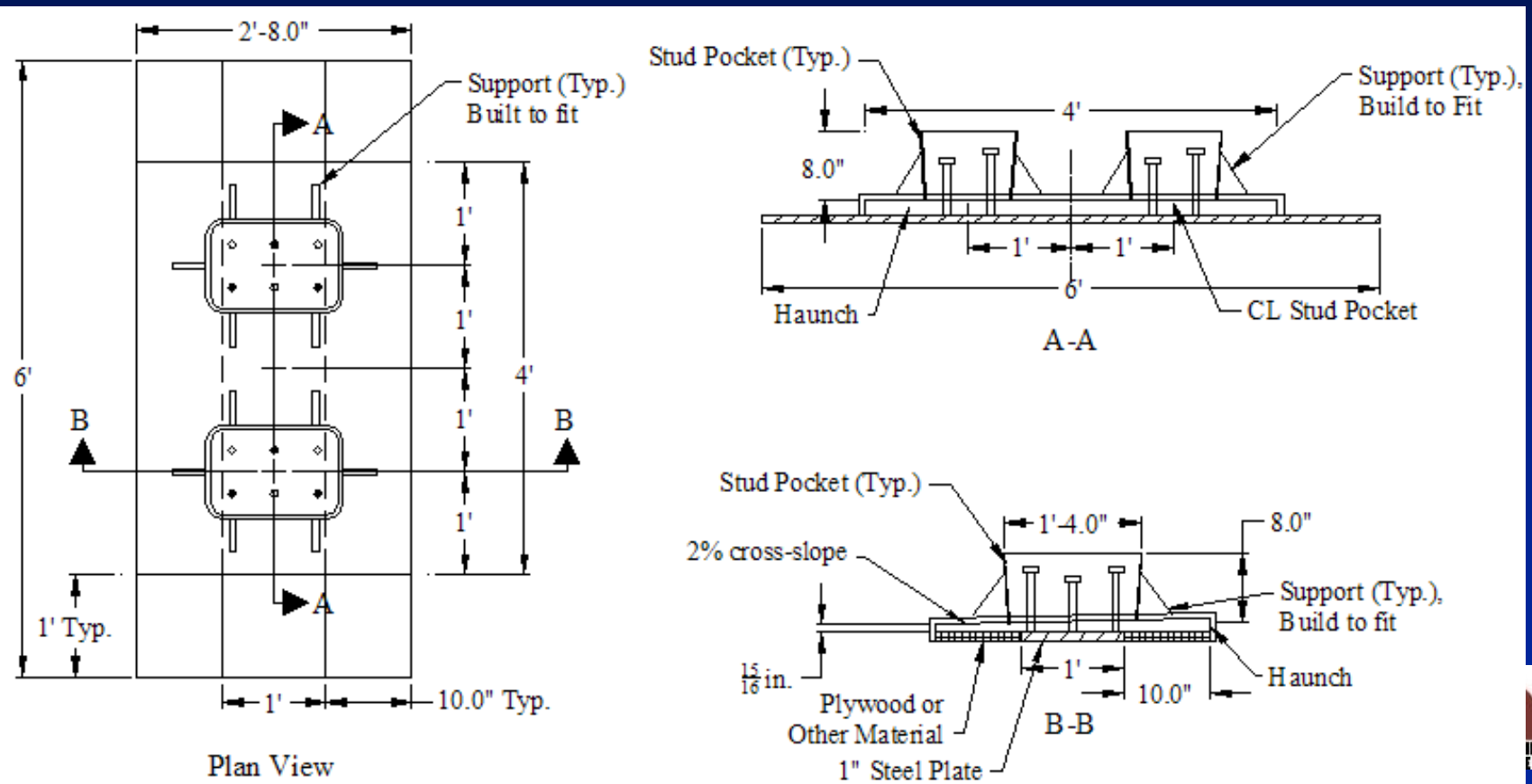



Laboratory Testing

- Grout flowability
 - Sufficient grout flow from stud pockets to haunch

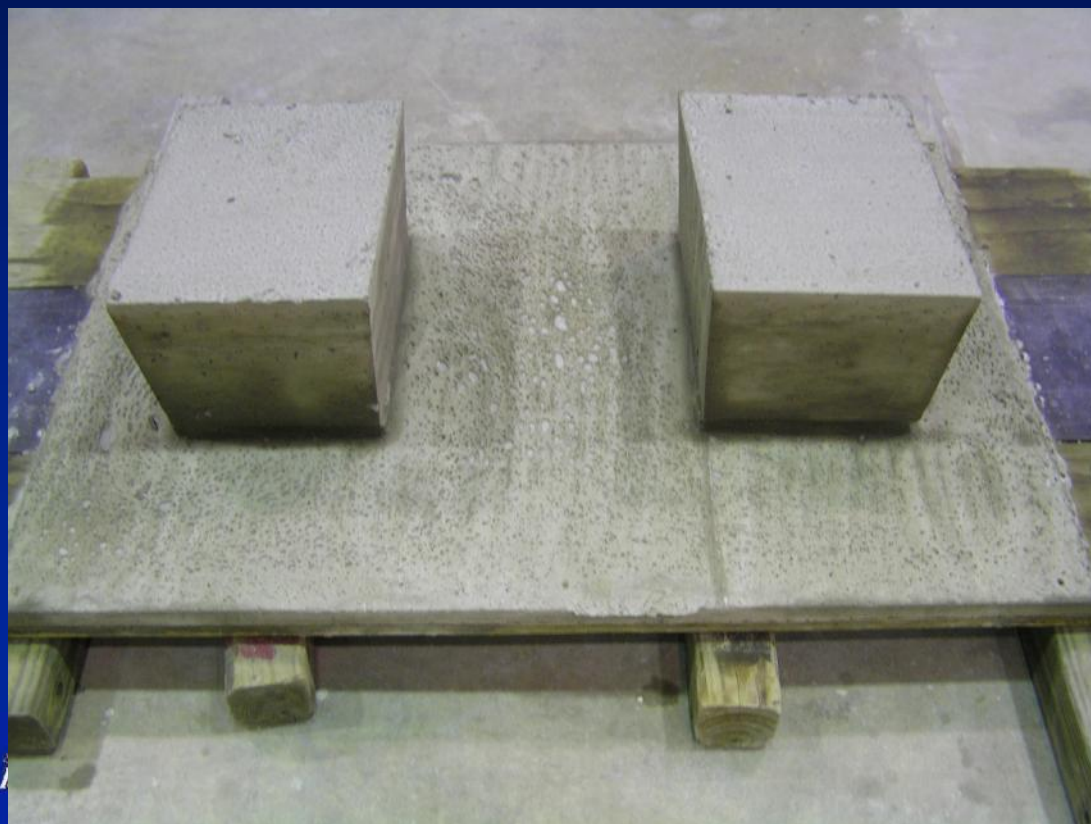

Laboratory Testing

- Duct splicing performance
 - 1 in. x 3 in. duct splice checked for grout tightness
 - Waterproof duct tape
 - » Simple
 - » Works



Laboratory Testing

- Panel transverse joint shear
- Surface treatments
 - Control (no roughing)
 - Diamond plate forms
 - Chemical etching
 - Sandblasting (best performance 578 psi)



Control Surface

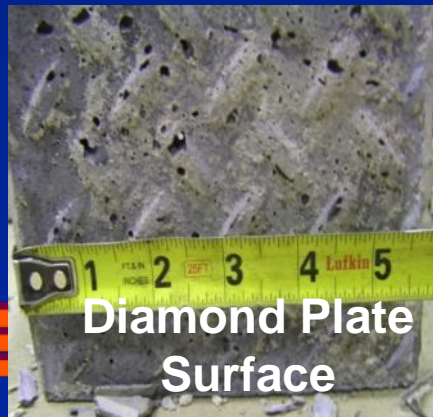

Diamond Plate Surface



Chemical Etched Surface



Sandblasted Surface

Field Testing

- Corrosion Monitoring
 - 6 pre-stress strands
 - 6 sacrificial post-tensioning strands

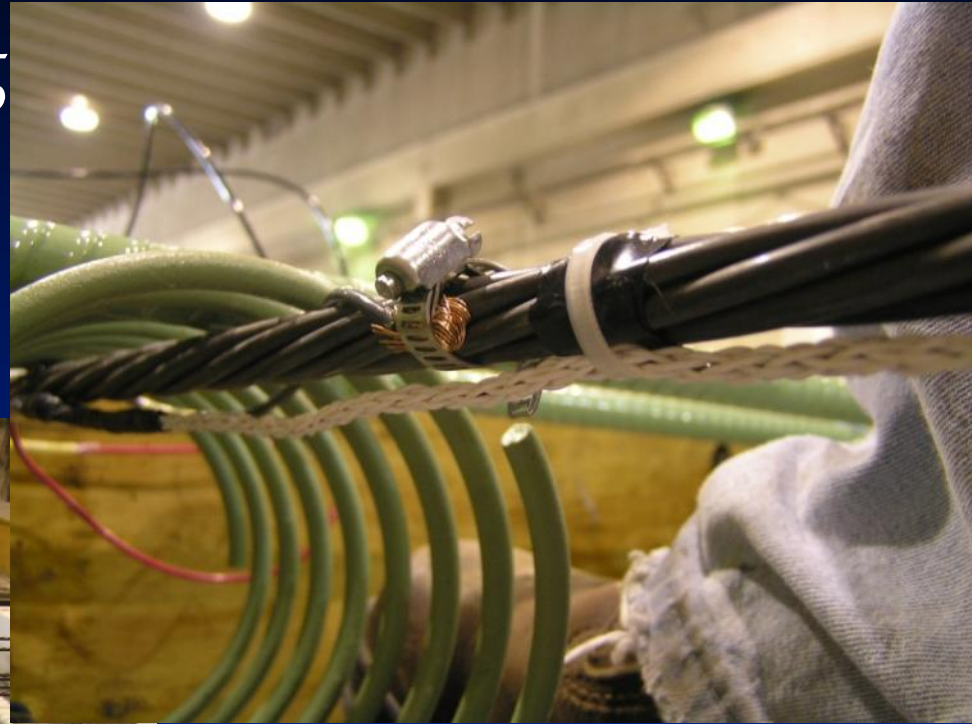

- No corrosion taking place as of June



Field Testing

- Handling Performance



Field Testing

- Panel Joint Pressure
 - Monitored during post-tension

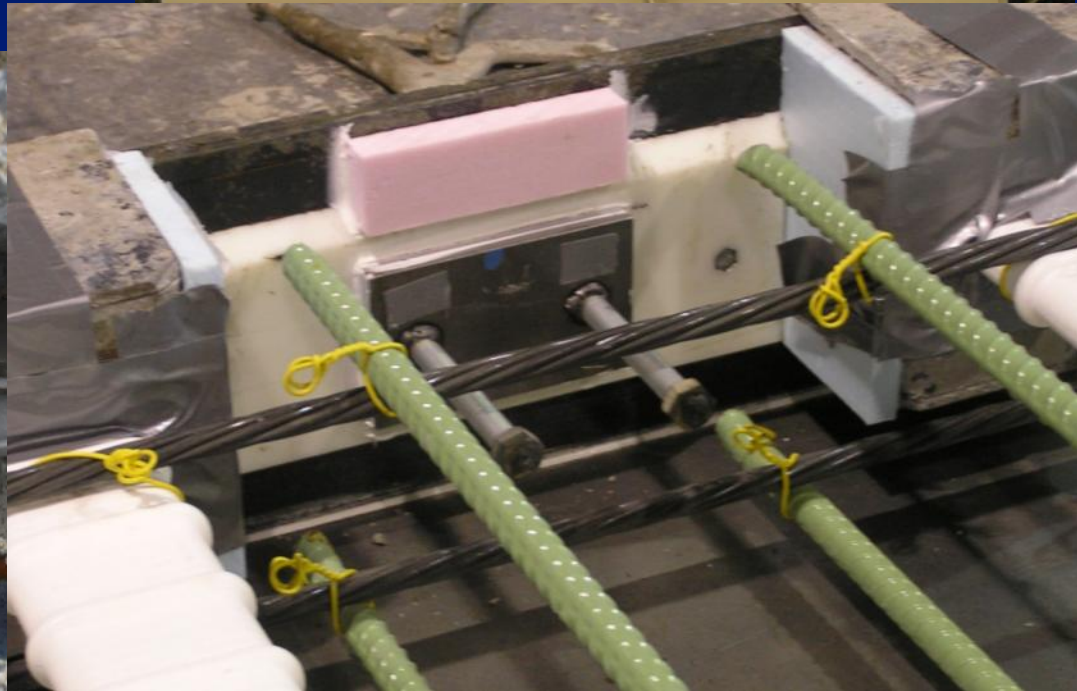
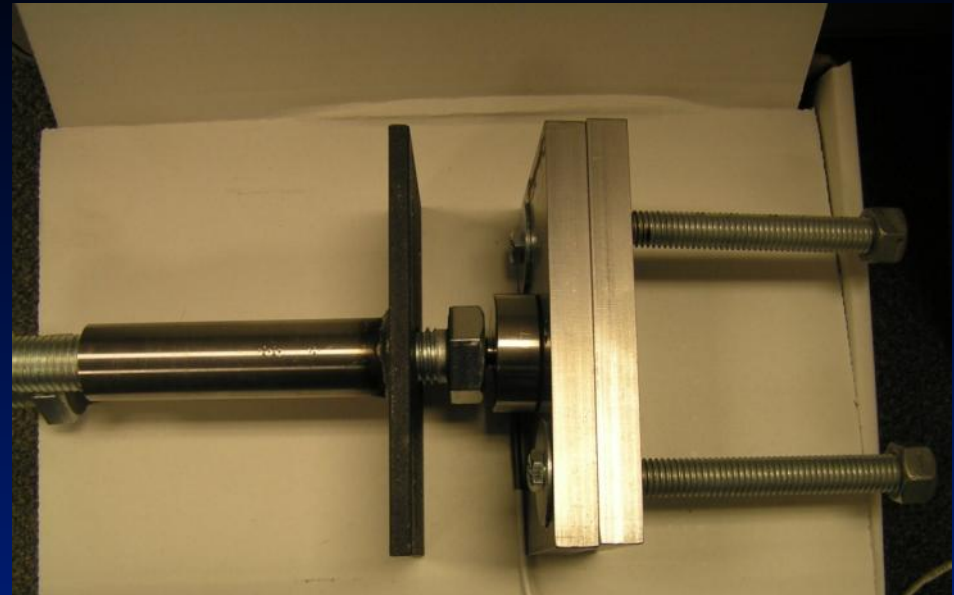

Field Testing

- Live load testing
 - Gauges located on north span
 - » Deflection, Strain, & Acceleration

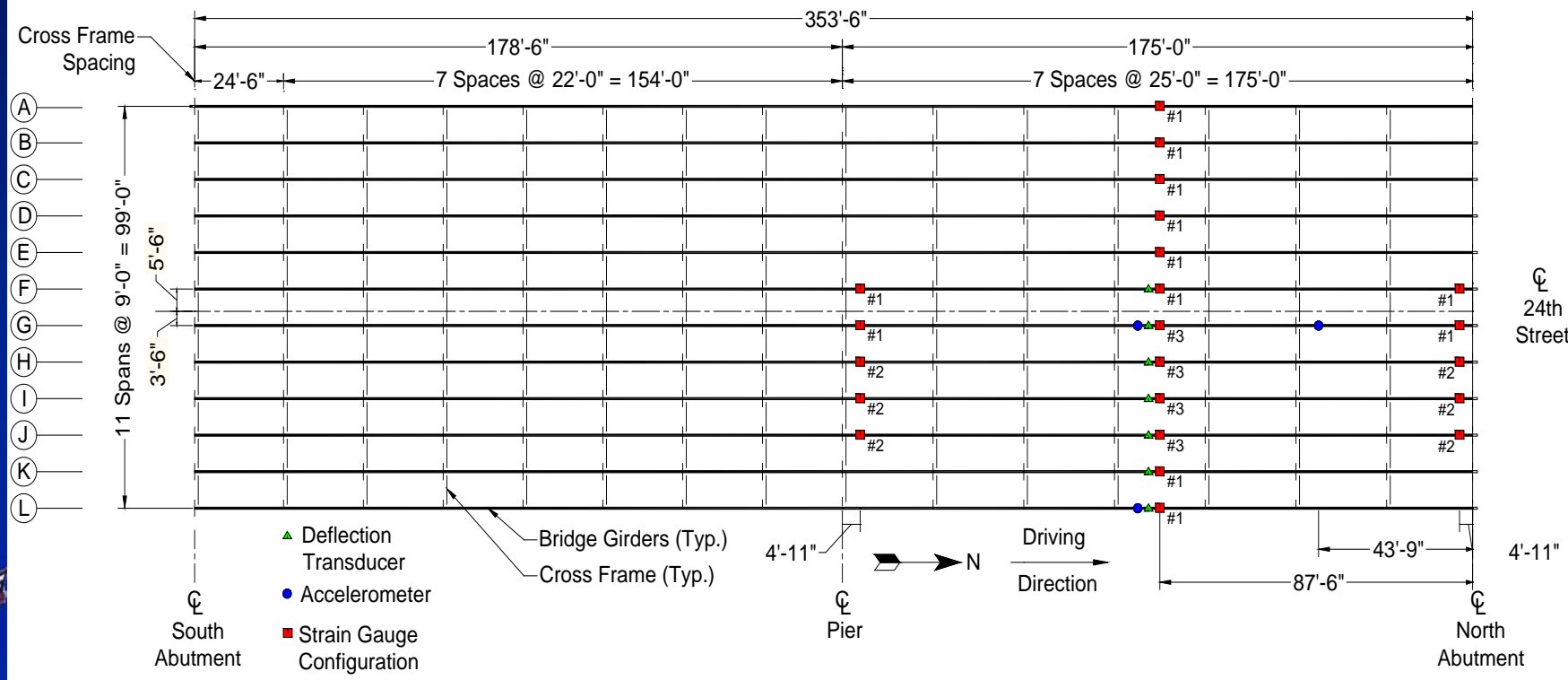



Field Testing

- Live load testing
 - 6 transverse load positions
 - Tandem axle dump truck

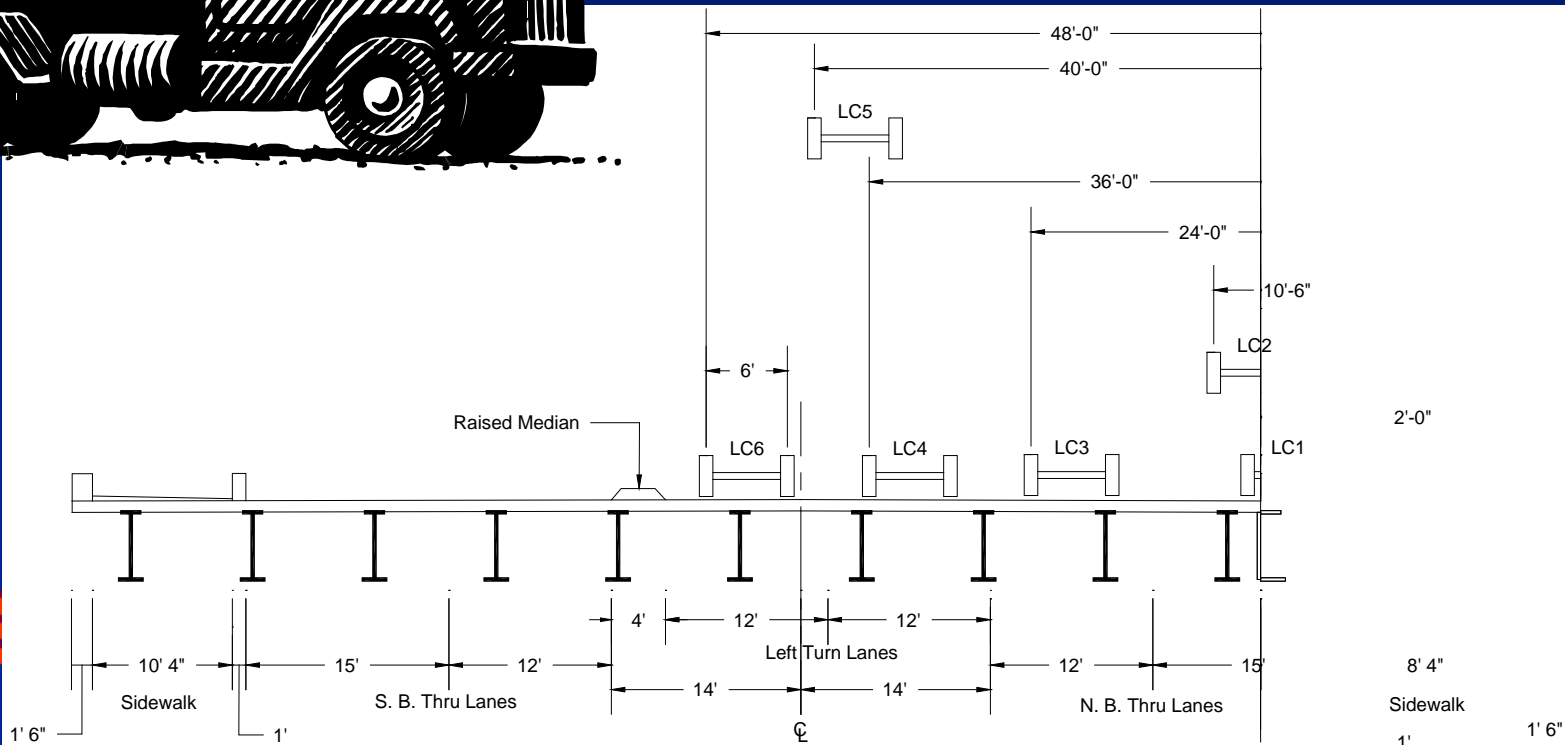
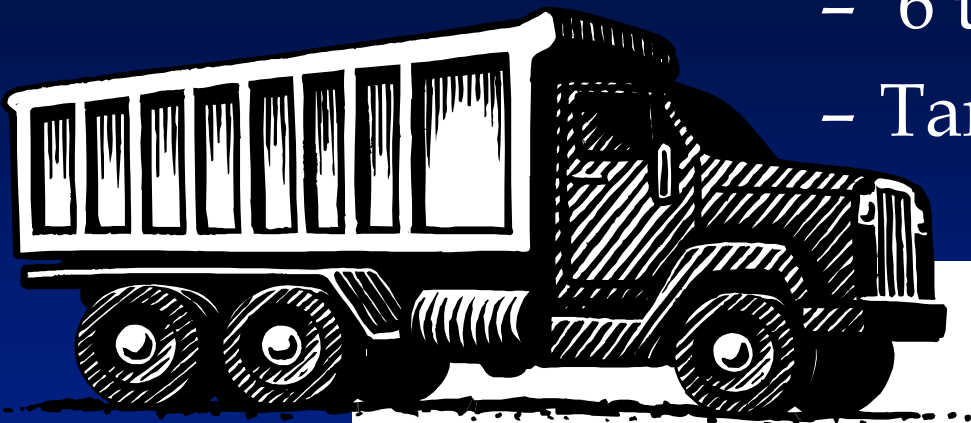

Field Testing

- Live load testing
 - Deflection @ midspan of north span
 - Truck on south span: max 0.15 in.
 - Truck on north span: min -0.31 in.

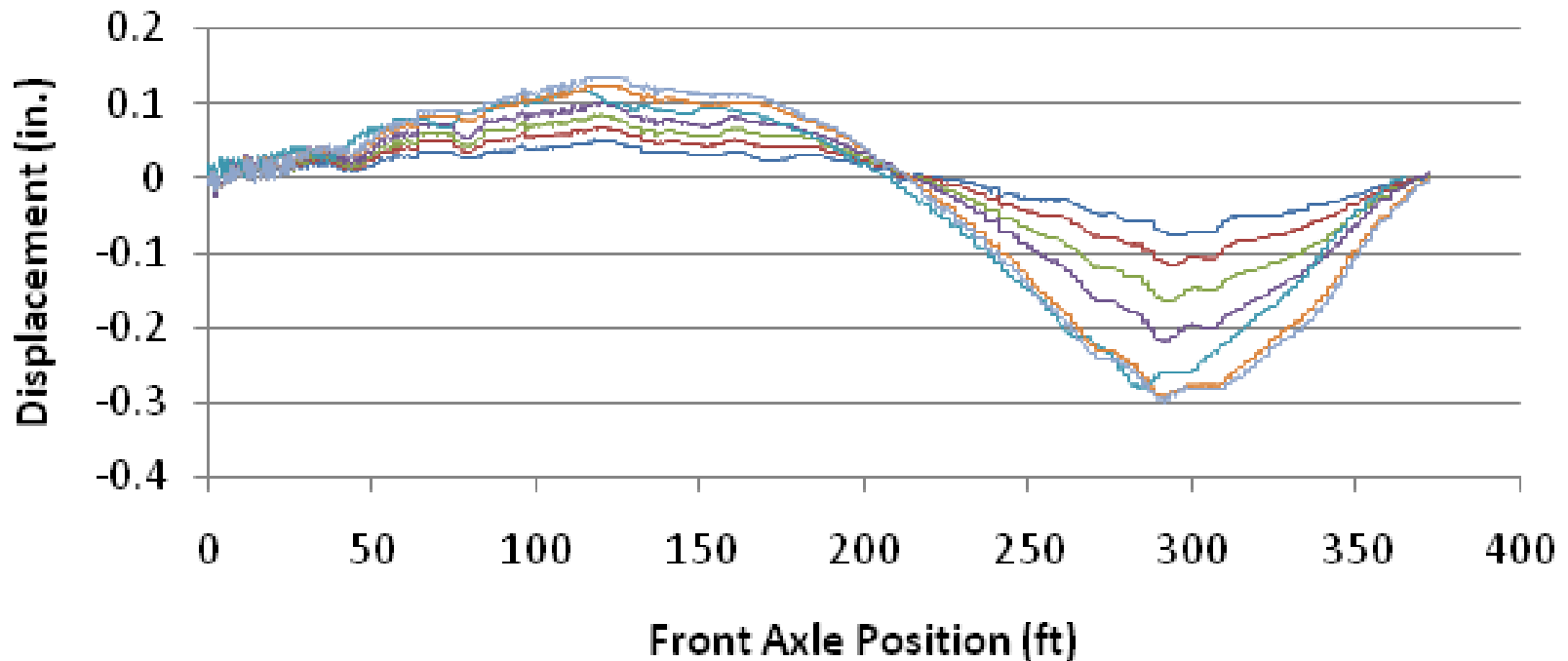



Field Testing

- Live load testing
 - Strain

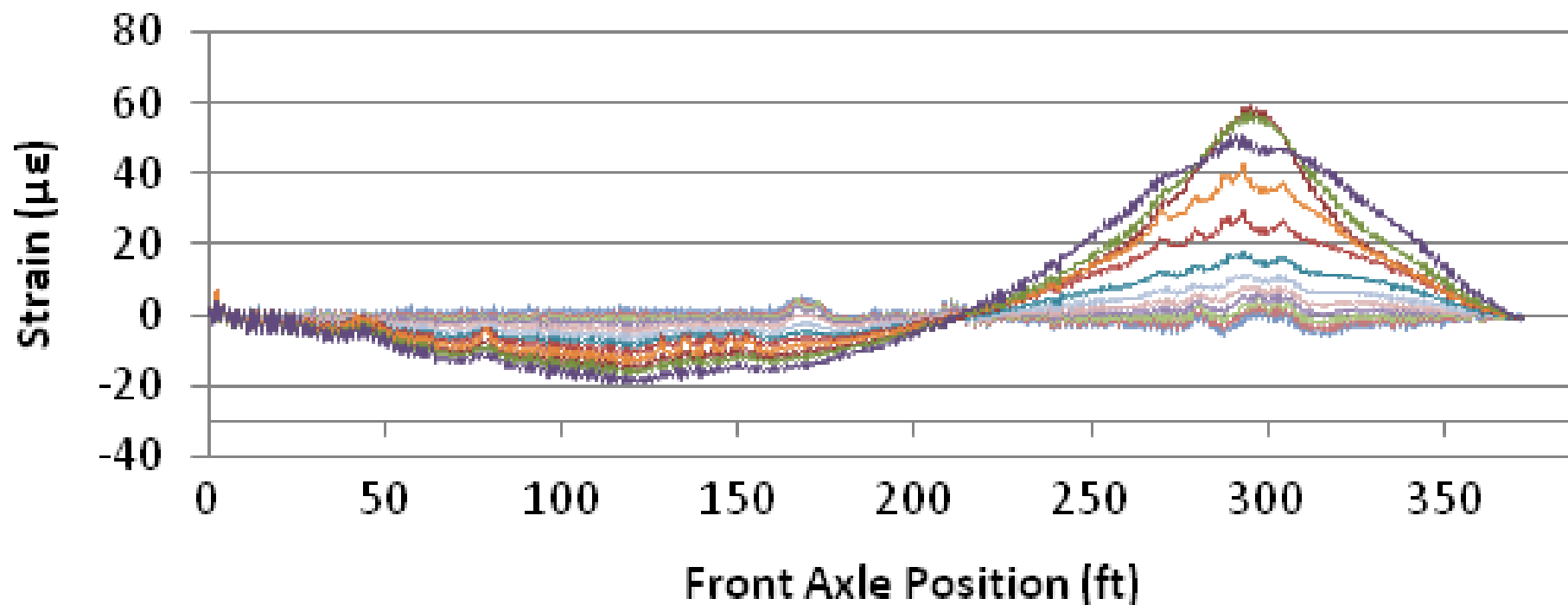

Field Testing

- Live load testing
 - Strain

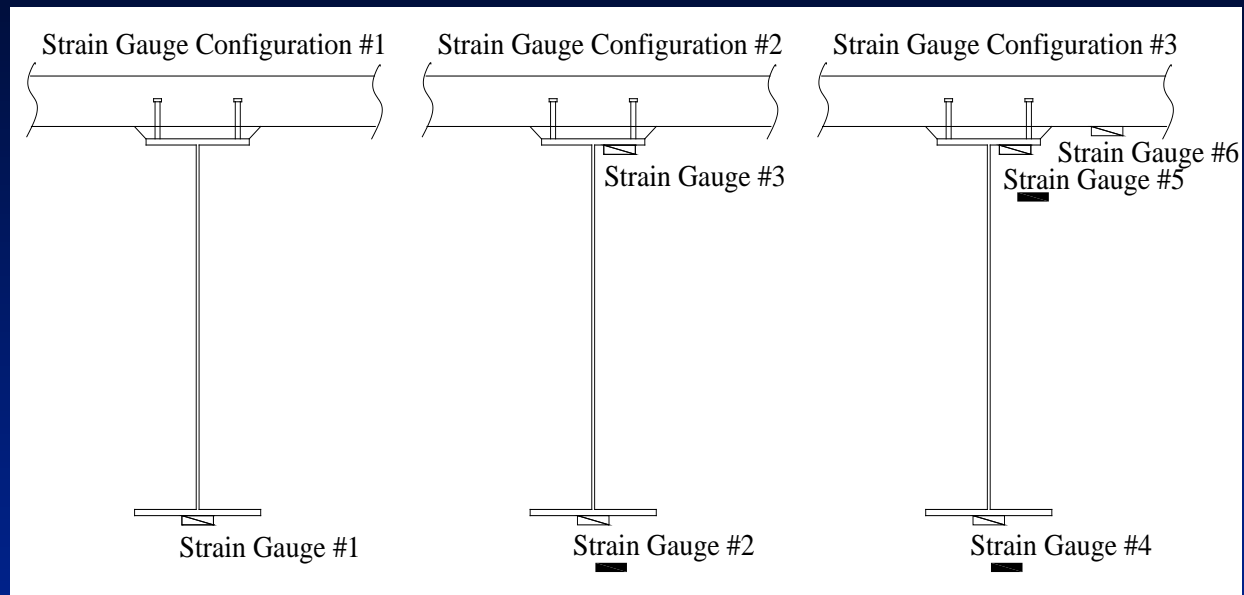

Strain ($\mu\epsilon$)

Gauge Location	Bottom Flange	Top Flange	Bottom of Slab
Abutment	-4 to +14	-5 to +6	NS
Pier	-16 to +3	-1 to +5	NS
Mid-span	-22 to +66	-5 to +5	-2 to +6

Conclusion & Recommendations

- Laboratory Testing
 - Stud pockets
 - » Installation
 - » Bend test
 - Grout can sufficiently flow from stud pocket into haunch
 - Waterproof duct tape is sufficient for sealing duct splices
 - Sandblasting surface of joint provide highest shear resistance



Conclusion & Recommendations

- Field Testing
 - No corrosion indicated
 - Minimal pressure at mid-span joint during post-tensioning
 - Deflections were less than $L/6770$
 - Max and minimum strain occurred at bottom flange mid-span
 - » Max tension $66\mu\epsilon$
 - » Max compression $22\mu\epsilon$

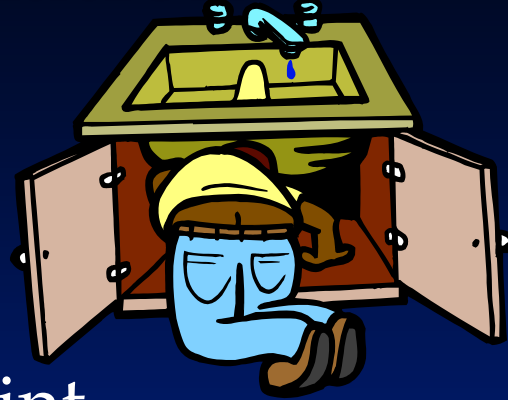

24th Street Bridge



• Questions??