

For joint details, see PV-101.

- ① Build curb to end of Reinforced Bridge Approach Sections. See Curb Location Details (Section B-B on BR-101).
- ② See BR-101.
- ③ Longitudinal Joints (PV-101):  
Single Pour - Saw cut joint per Detail B.  
Two Pours - Use 'KS-1' joint.
- ④ Excavation limits of Modified Subbase 2 feet outside of pavement edge, see BR-101.
- ⑤ Minimum 2 panels, maximum 3 panels 20 foot panel length. Use 'CD' joints.
- ⑥ The contractor may need to saw cut the HMA pavement full depth to accommodate the 'B' joint.
- ⑦ Place 'RD' joint where PCC shoulder. Place 'B' joint otherwise.

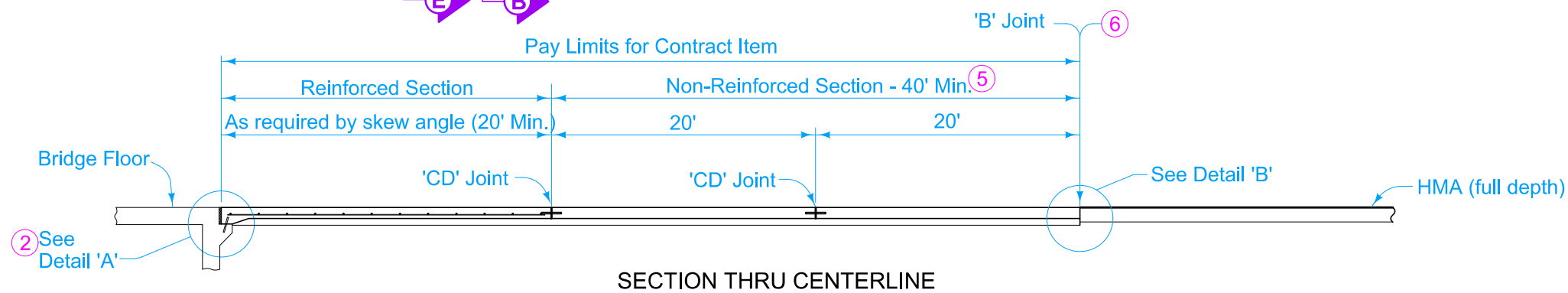

Possible Contract Item:  
Bridge Approach, Two Lane  
Longitudinal Grooving in Concrete, Bridge Deck  
Longitudinal Grooving in Concrete, Pavement

Possible Tabulation:  
112-6

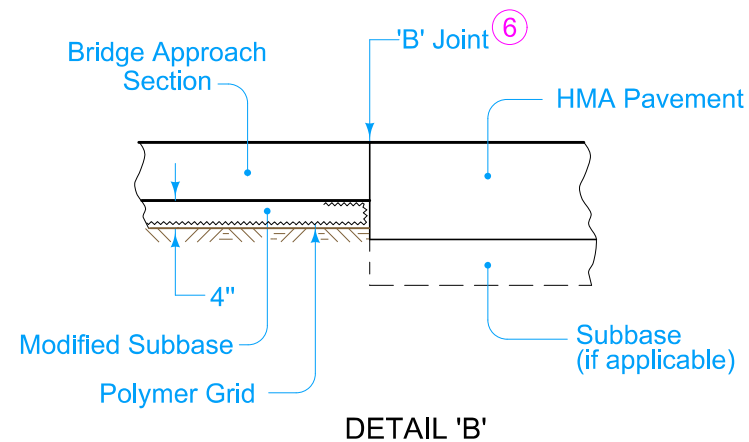
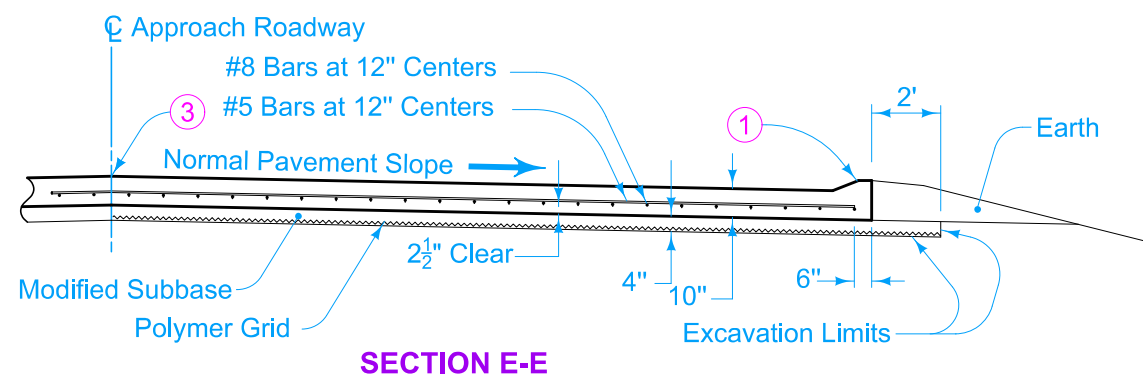

 <b>STANDARD ROAD PLAN</b>	REVISION	
	1	10-15-24
<b>BR-107</b>		
SHEET 1 of 1		
REVISIONS: Added Longitudinal Grooving in Concrete to possible contract item.		
 APPROVED BY DESIGN METHODS ENGINEER		
<b>BRIDGE APPROACH SECTION</b> <b>(AT EXISTING BRIDGES, HMA PAVEMENT)</b>		