

DESIGNER INFORMATION

Obtain the Engineer's approval for location of stabilized entrances prior to constructing.

- ① Place engineering fabric prior to placing aggregate. Use fabric for Embankment Erosion Control complying with Section 4196 of the Standard Specifications.
- ② Use aggregate meeting Gradation No. 13a of Section 4109 of the Standard Specifications.
- ③ Depth may need to be increased depending on the weight of contractor vehicles and equipment.

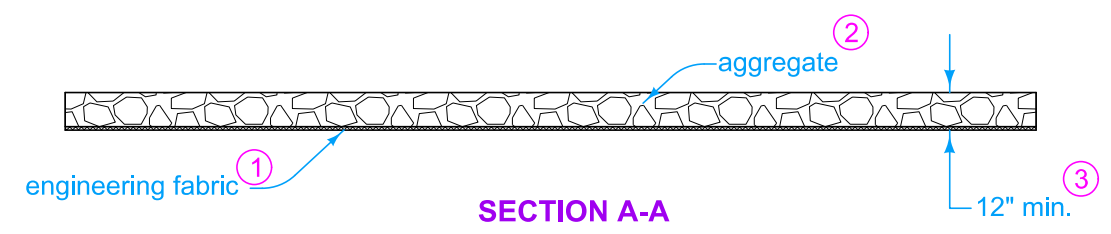
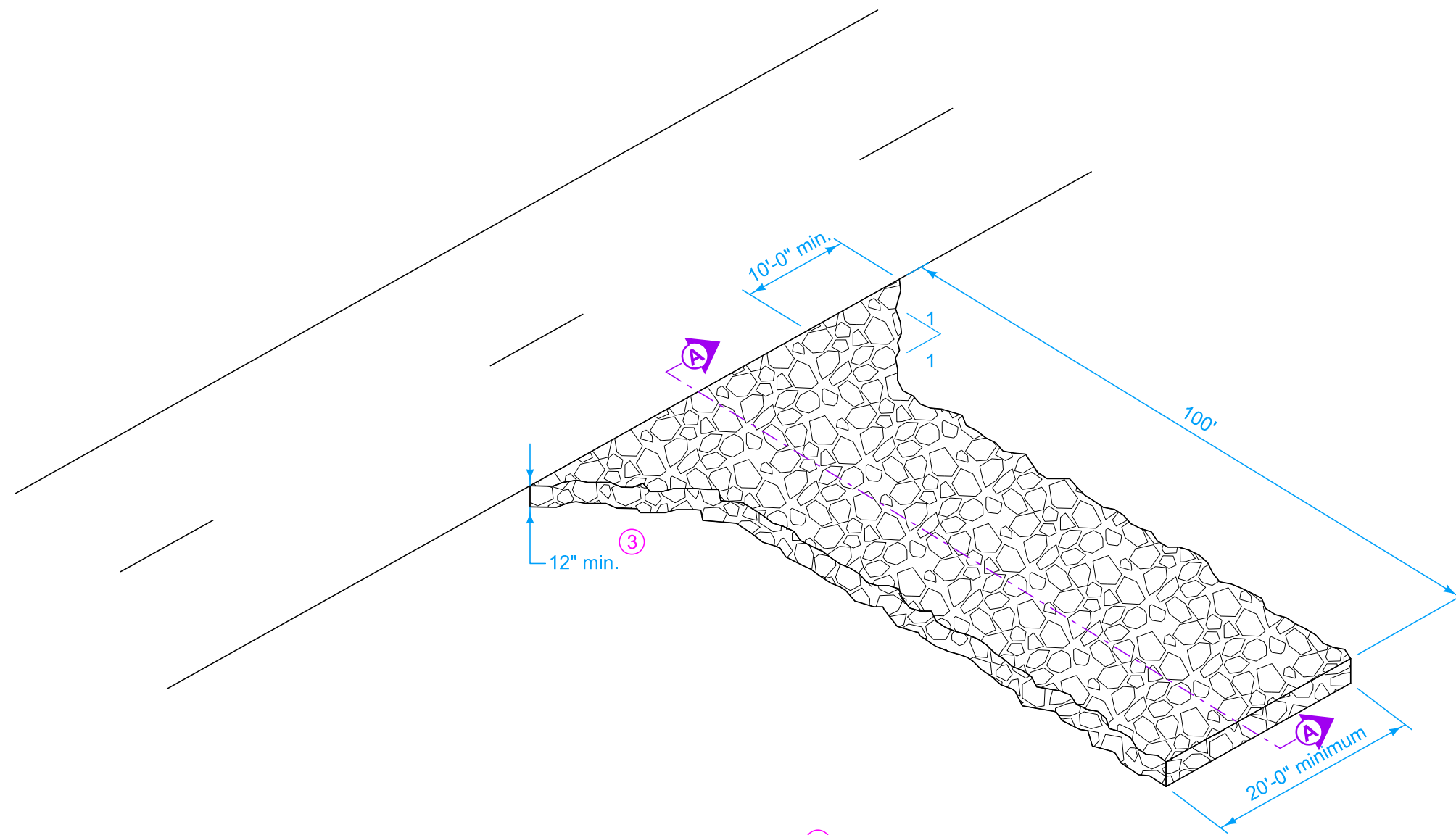

| | | |
|--|----------|---------------|
| | REVISION | |
| | 4 | 10-19-21 |
| STANDARD ROAD PLAN | | EC-303 |
| | | SHEET 1 of 1 |
| REVISIONS: Defined length to be 100', to be consistent with spec change. | | |
| | | |
| APPROVED BY DESIGN METHODS ENGINEER | | |
| STABILIZED CONSTRUCTION ENTRANCE | | |