

**POSSIBLE PATCH LOCATIONS**

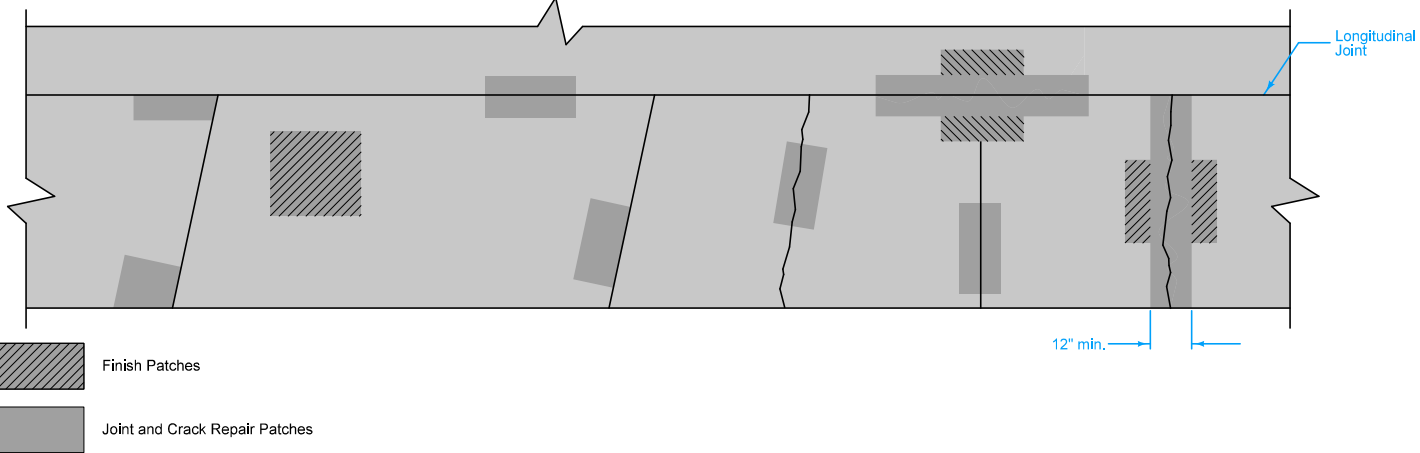

See **PV-101** for jointing.

- ① One per panel.
- ② If joint or crack is within patch area, construct bottom edge of patch at least 3 inches beyond crack or joint.

**PARTIAL DEPTH PATCH**

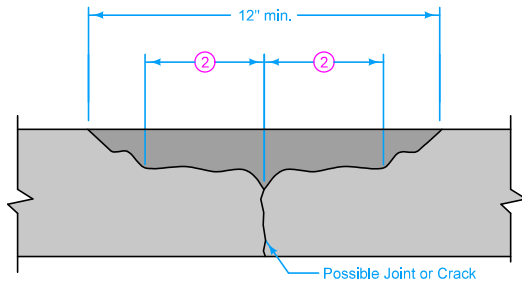

**TYPICAL SECTION**

**OVERDEPTH PATCH**

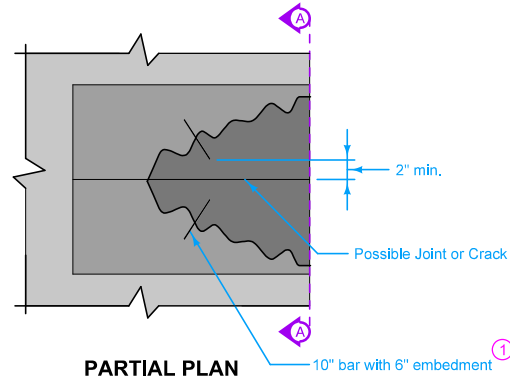

**PARTIAL PLAN**

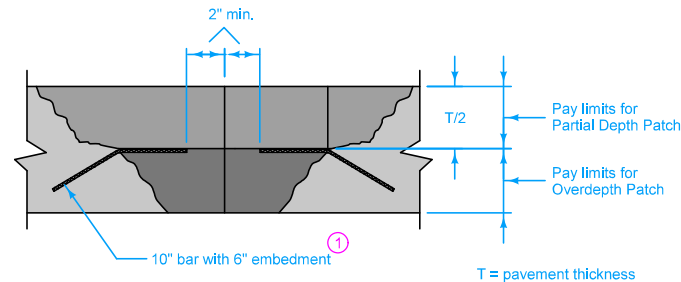

**SECTION A-A**



Possible Contract Items:  
 Partial Depth PCC Finish Patches  
 Partial Depth PCC Joint and Crack Repair Patches  
 Overdepth Patches

Possible Tabulation:  
 102-10

<b>IOWA DOT</b>	REVISION	
	1	10-16-18
	<b>STANDARD ROAD PLAN</b>	
<b>PR-107</b>		SHEET 1 of 1

REVISIONS: Removed "Modified" from the standard.

*[Signature]*  
 APPROVED BY DESIGN METHODS ENGINEER

**PARTIAL DEPTH PCC FINISH PATCHES**