

PLAN Transverse Joint

Do not groove temporary pavement markings.

- ① Center 6 inch gap over longitudinal joint.

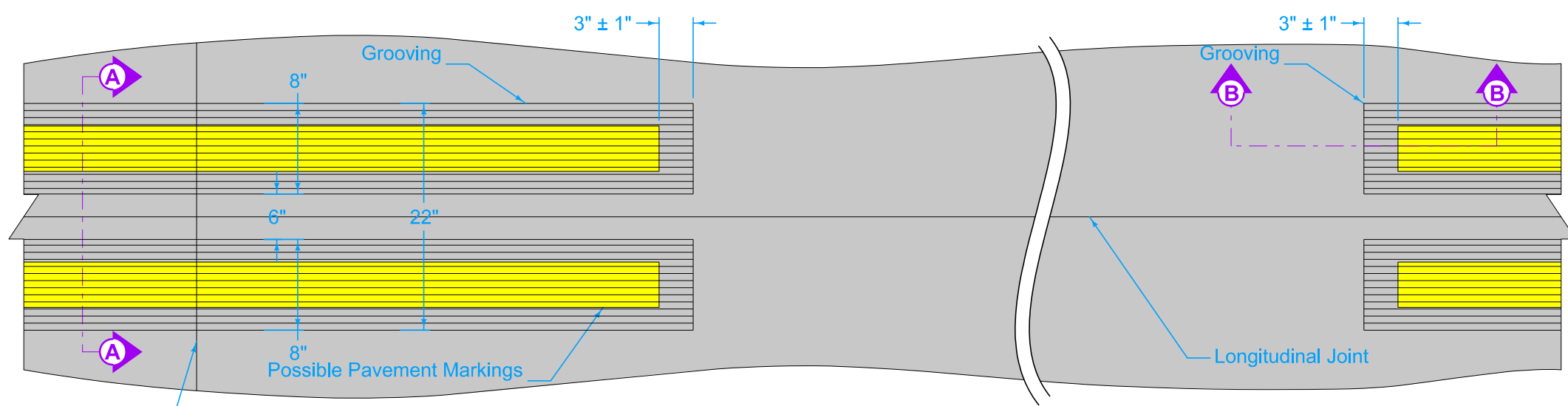

PLAN

Transverse Joint

Possible Contract Item:  
Grooves Cut for Pavement Markings

Possible Tabulation:  
108-22

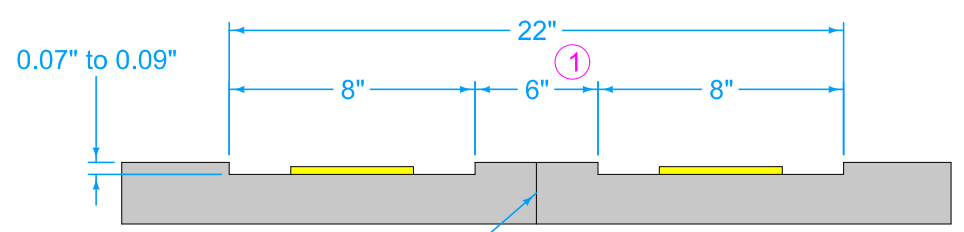

SECTION A-A  
CROSS-SECTION

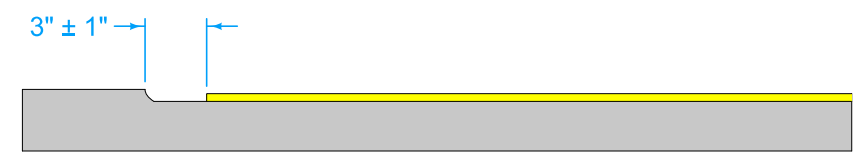

SECTION B-B  
PROFILE

<b>IOWA DOT</b> <b>STANDARD ROAD PLAN</b>	REVISION	
	1	04-15-25
		<b>PM-115</b>
		SHEET 1 of 4

REVISIONS: Modified note 2.

*Steve Miller*  
APPROVED BY DESIGN METHODS ENGINEER

**GROOVING FOR  
LINE TYPES**

BCY# BLW# BROKEN CENTERLINE

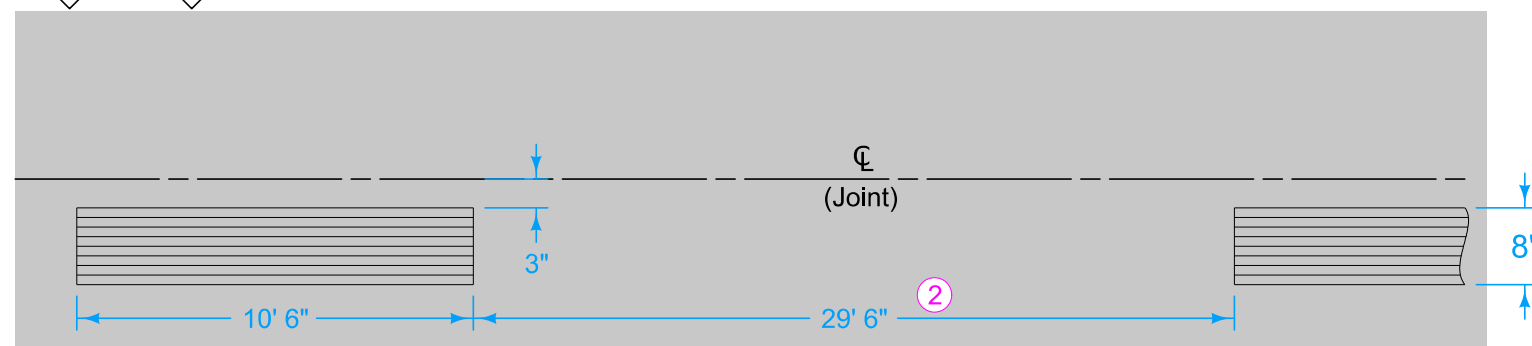

SLW# SOLID LANE LINE

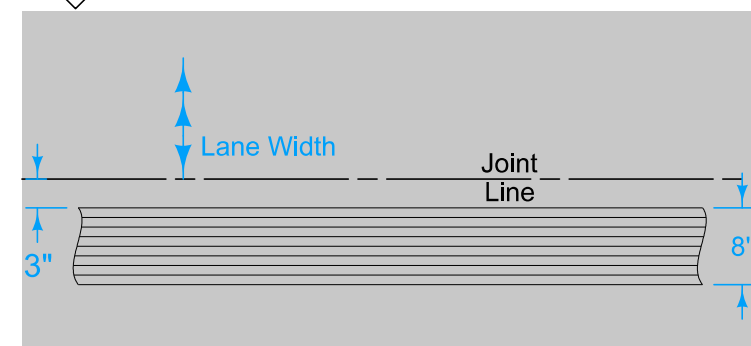

② Do not continuously groove broken line styles.

NPY# NO PASSING ZONE LINE

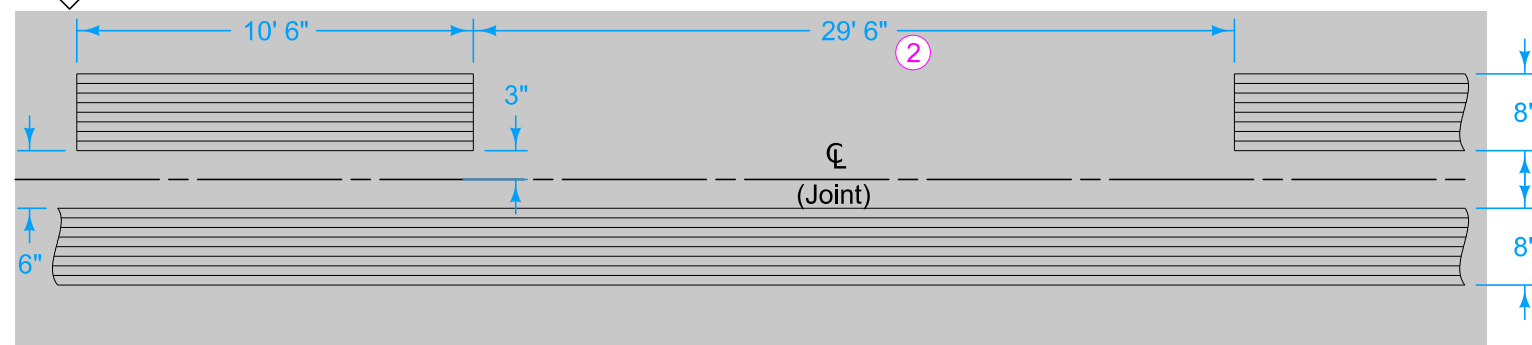

DLY# DLW# DOTTED LINE

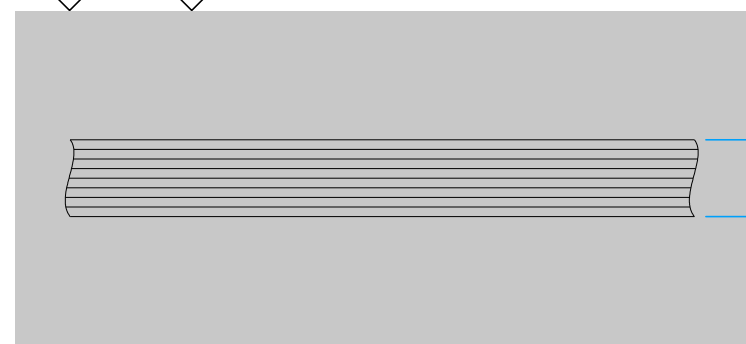

RLW# ELW# ELY# RLY# EDGE LINE

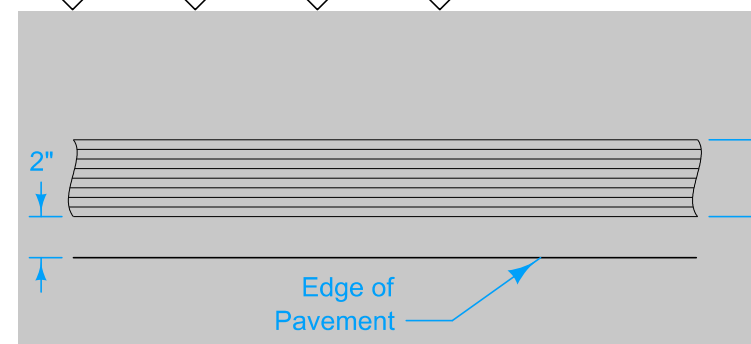

DCY# DOUBLE CENTERLINE DDY# DOUBLE DOTTED LINE

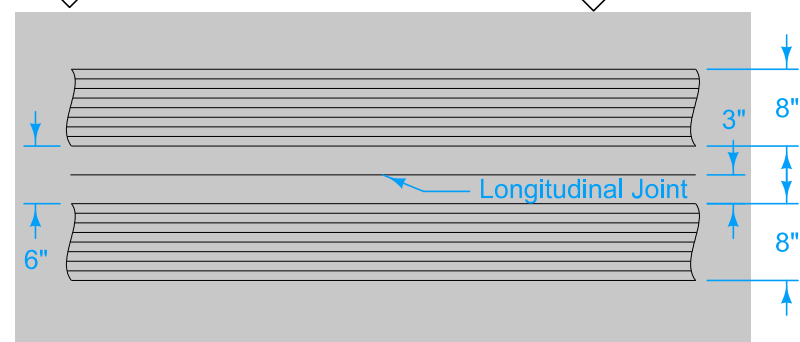

	REVISION
	1   04-15-25
<b>STANDARD ROAD PLAN</b>	<b>PM-115</b>
REVISIONS: Modified note 2.	SHEET 2 of 4
 APPROVED BY DESIGN METHODS ENGINEER	
<b>GROOVING FOR LINE TYPES</b>	

CHY8 CHW8 CHANNELIZING LINE LDW8 LANE DROP

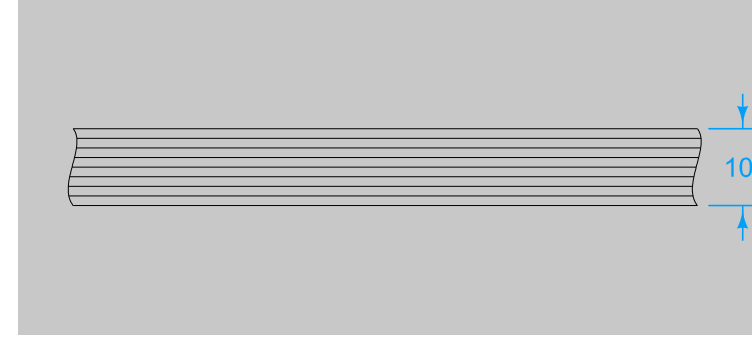

CHY10 CHW10 CHANNELIZING LINE LDW10 LANE DROP

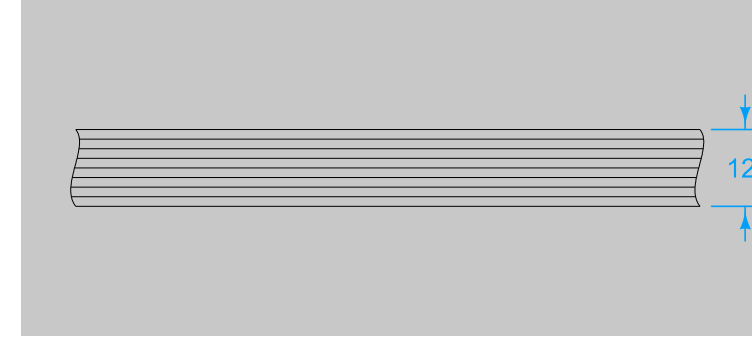

② Do not continuously groove broken line styles.

BLC6 BROKEN LANE LINE

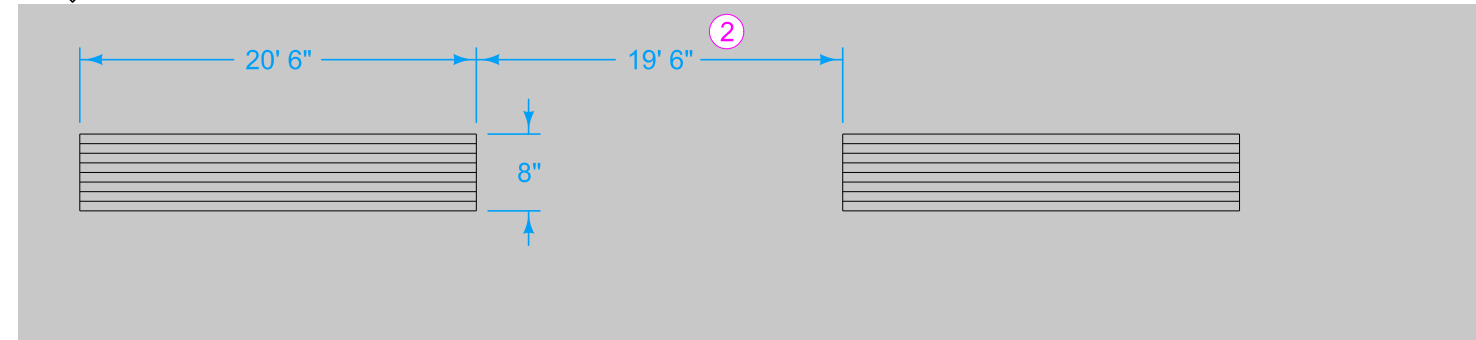

CBW6 CROSSWALK BAR

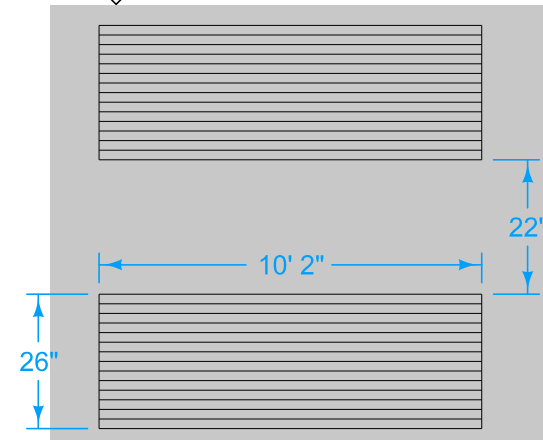

CLW6 CROSSWALK LINE

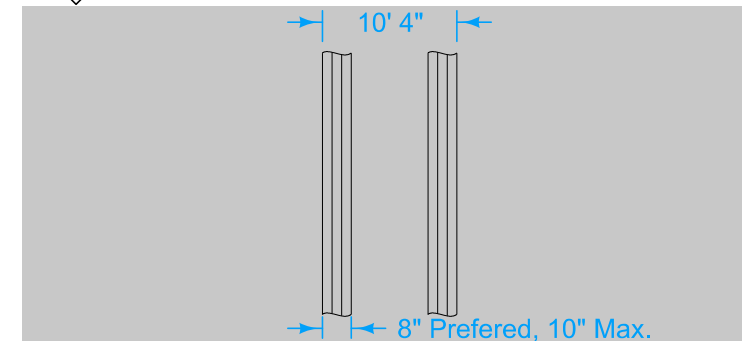

SLW2 YLW2 STOP LINE / YIELD LINE

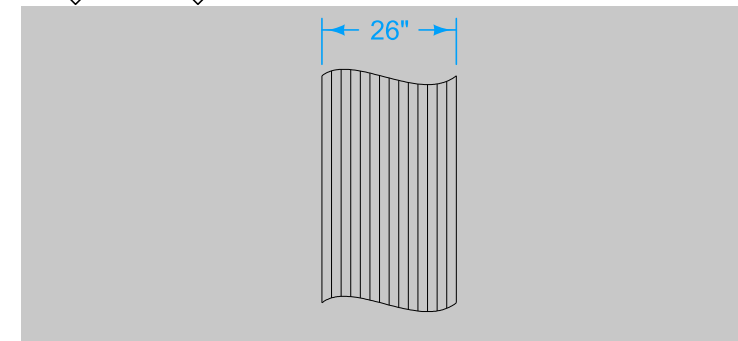

<b>IOWA DOT</b> <b>STANDARD ROAD PLAN</b>	REVISION	
	1	04-15-25
		<b>PM-115</b>
		SHEET 3 of 4

REVISIONS: Modified note 2.

*Shawn Miller*  
 APPROVED BY DESIGN METHODS ENGINEER

**GROOVING FOR  
 LINE TYPES**

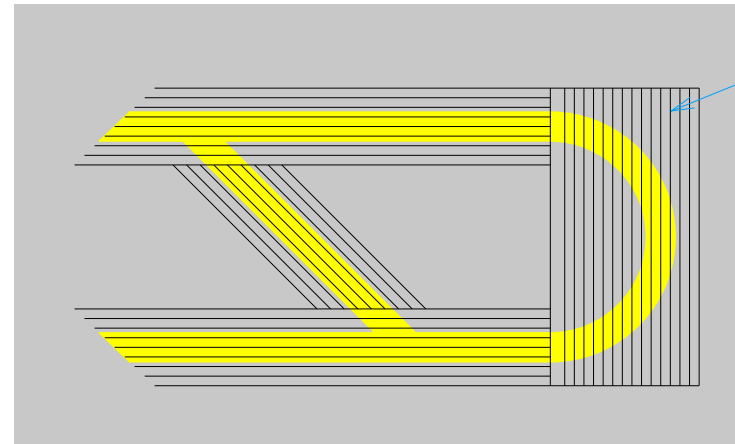
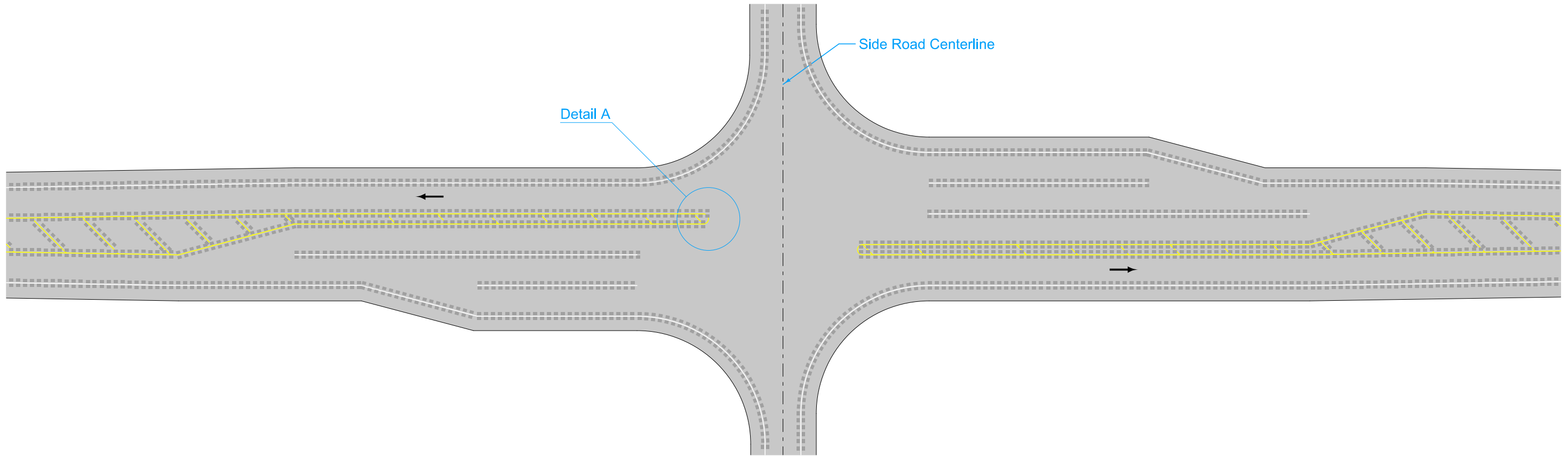
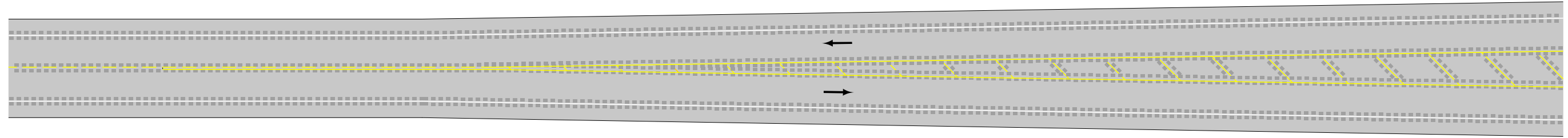

Detail A

PAINTED MEDIAN

	REVISION	
	1	04-15-25
<b>STANDARD ROAD PLAN</b>		<b>PM-115</b>
REVISIONS: Modified note 2.		SHEET 4 of 4
APPROVED BY DESIGN METHODS ENGINEER		
<b>GROOVING FOR LINE TYPES</b>		