

For line information, see PM-110.

For projects not on the Primary system the following substitutions may be made. See plan sheets for substitutions.

ELW6 → ELW4
 NPY6 → NPY4
 BCY6 → BCY4
 BLW6 → BLW4

① If distance X is less than 3000 feet, omit last R4-3 sign. If distance X is greater than 5250 feet, place R4-3 signs at 2250 foot intervals.

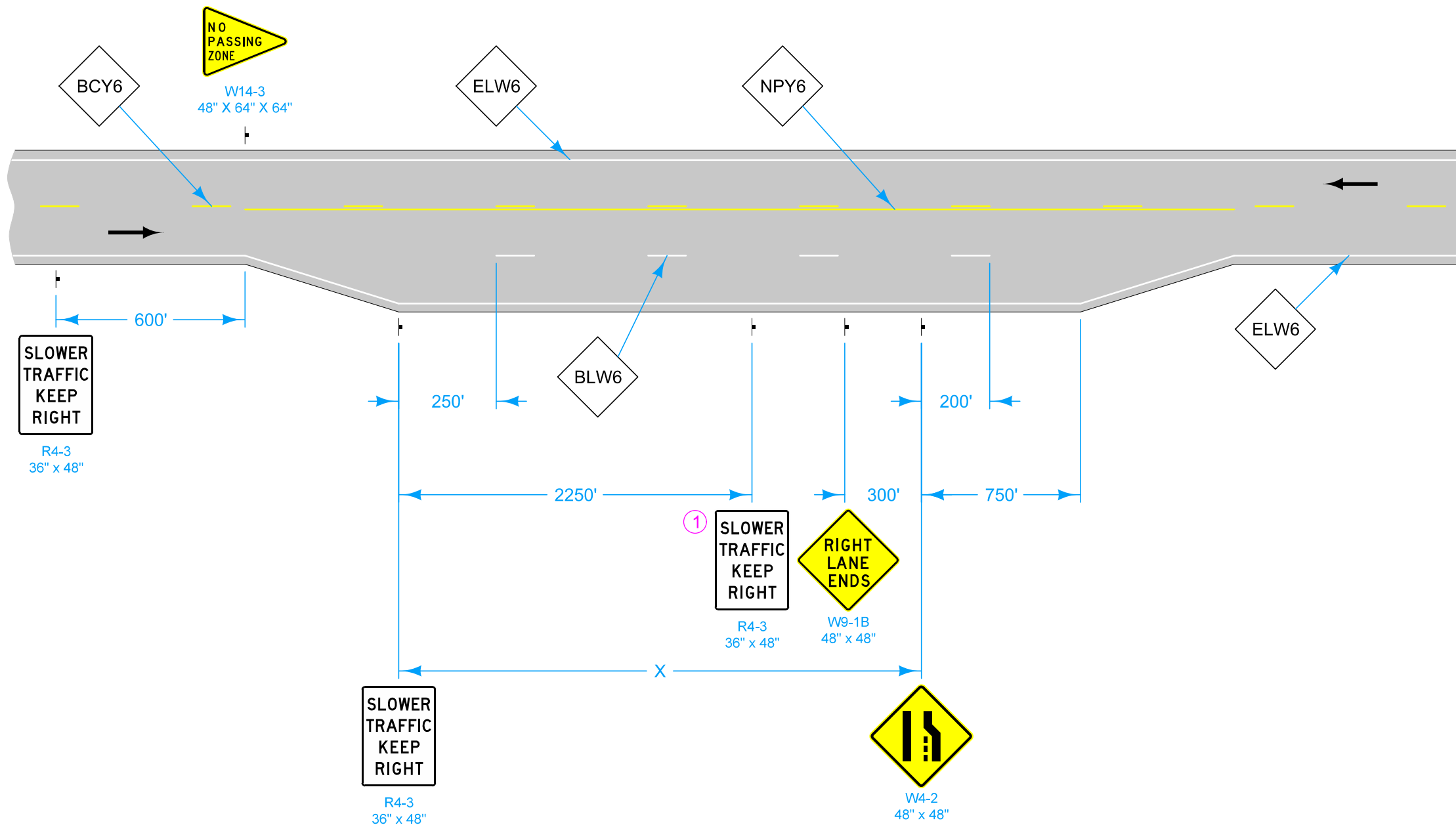

LEGEND	
←	Direction of Traffic
BCY6	Broken Centerline (Yellow)
BLW6	Broken Lane Line (White)
ELW6	Edge Line Right (White)
NPY6	No Passing Zone Line (Yellow)

Possible Contract Item:
 Pavement Marking Line Items
 Type 'A' Signs

Possible Tabulation:
 108-22

	REVISION	
	2	10-15-24
STANDARD ROAD PLAN		PM-221
		SHEET 1 of 1
REVISIONS: Modified line widths from 4 inches to 6 inches.		
 APPROVED BY DESIGN METHODS ENGINEER		
CLIMBING LANE		