

WHERE AN INTERCHANGE IS LOCATED AT THE LAST PUBLIC ROAD PRIOR TO AREA OF RESTRICTED WIDTH

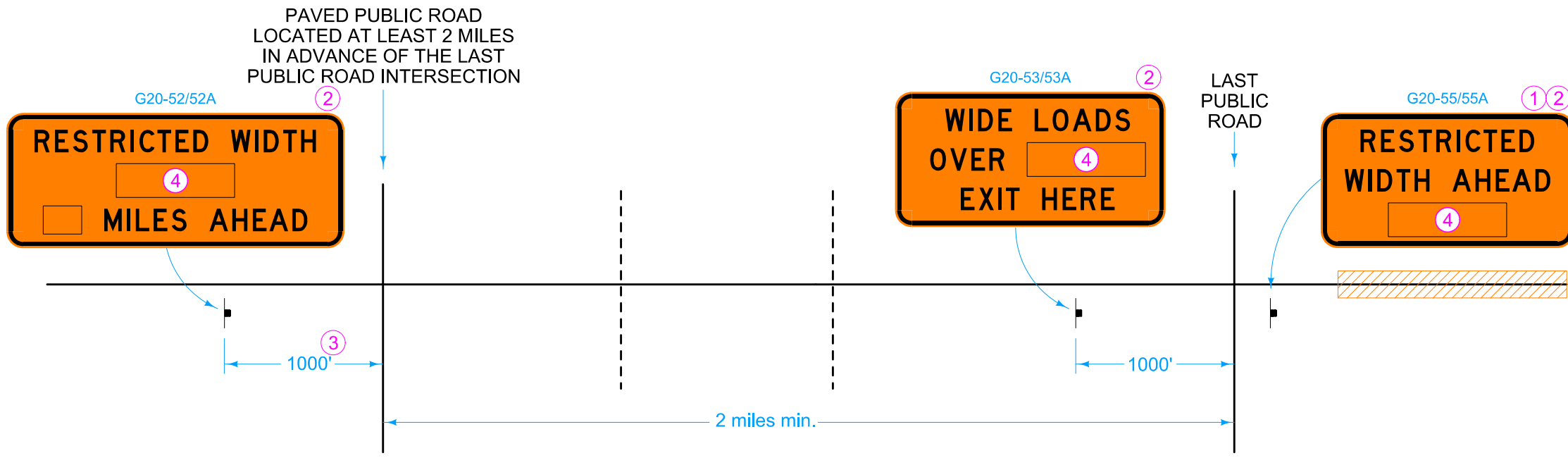

WHERE AN AT-GRADE INTERSECTION IS LOCATED AT THE LAST PUBLIC ROAD PRIOR TO AREA OF RESTRICTED WIDTH

LEGEND	
	Area of Restricted Width
	Traffic Sign

Coordinate signing in conjunction with other traffic control in the area.

Exact sign locations will be as approved by the Engineer.

For multi-lane divided roadways, use larger sign sizes. For two-lane highways, use small sign sizes.

See SI-882 for sign details.

Place restricted width signing when the available width between two fixed objects, such as concrete barriers, is reduced to less than 15 feet 6 inches. Width restriction signing will not be required for narrow lanes created by non-fixed devices, such as channelizers or pavement markings.

- ① Place after ROAD WORK AHEAD sign.
- ② For divided highways, install two signs at each location: One each on right and left shoulders.
- ③ When this paved road intersection has an interchange, measure the distance from the beginning of the exit ramp taper.
- ④ Dimension on G20-58/58A panel equals 1 foot less than narrowest measurement.

Possible Contract Item:  
Traffic Control

 <b>STANDARD ROAD PLAN</b>	REVISION
	3   04-18-23
	<b>TC-81</b>
SHEET 1 of 1	

REVISIONS: Added note clarifying when standard is needed to be used. Changed title from 14.5' to 15.5'.

*Stuart Miller*  
APPROVED BY DESIGN METHODS ENGINEER

**RESTRICTED WIDTH SIGNING  
(LESS THAN 15.5 FEET)**