

Highway and Transportation Map

HARDIN COUNTY IOWA

Prepared By



Iowa Department of Transportation

Phone (515) 239-1289

In Cooperation With

United States Department of Transportation

1986

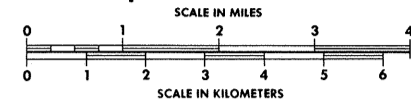

LEGEND

COUNTY LINE	---
CIVIL TOWNSHIP	---
CORPORATION LINE	---
SECTION LINE	---
INTERMITTENT STREAM	---
NARROW STREAM	---
PIPE LINE OIL	---
HIGHWAY BRIDGE SMALL	---
RAILROAD SINGLE OPERATING COMPANY	---
RAILROAD STATION	---
RAILROAD BELOW(OVERHEAD)	---
RAILROAD OVER (SUBWAY)	---
CENTER OF CITIES	---
CENTER OF COUNTY SEAT	---
RAILROAD GRADE CROSSING	---
LAKE OR POND	---
STATE OR FEDERAL PROPERTY (NAMED)	---
DELIMITING AREA (GENERALIZED)	---
WIDE STREAM	---
UNDERGROUND PHONE CABLE	---
UNIMPROVED ROAD (RURAL)	---
GRADED AND DRAINED ROAD	---
GRAVEL ROAD	---
BITUMINOUS SURFACED ROAD	---
PAVED ROAD	---
LEGAL ROAD NOT OPEN TO TRAFFIC	---
ABANDONED RAILROAD TRACK (TRACK RETAINED)	---

LEGEND

FARM UNIT	---
DWELLING OTHER THAN FARM	---
ROWS OR GROUPS OF DWELLINGS	---
STORE OR SMALL BUSINESS ESTABLISHMENT	---
CHURCH OR OTHER RELIGIOUS INSTITUTION	---
SCHOOL OR OTHER EDUCATIONAL INSTITUTION	---
CEMETERY	---
CORRECTIONAL INSTITUTION	---
TRIANGULATION STATION	---
COUNTY HOME	---
POND OR LAKE WITH DAM	---
UNITED STATES HIGHWAY	---
STATE HIGHWAY SYSTEM	---
COUNTY TRUNK SYSTEM	---
FEDERAL AID HIGHWAY SYSTEM	---
POINTS BETWEEN WHICH DISTANCES ARE MEASURED	---
LANDING AREA OR STRIP	---
DRIVE-IN THEATER	---
COMBINED DWELLING AND STORE	---
Gauging or Pumping Station	---
GRAVEL PIT	---
SEASONAL OR SUMMER COLODY DWELLING	---
BOOSTER STATION	---
COMMUNITY HALL	---
RIFLE CLUB	---
ARMORY	---
WAYSIDE PARK	---
GARBAGE OR RUBBISH DUMP	---
GOLF CLUB	---
AIRPORT, LIMITED FACILITIES	---
AUTO JUNK YARD	---
LAND FILL	---
RELAY TOWER	---
WELL	---

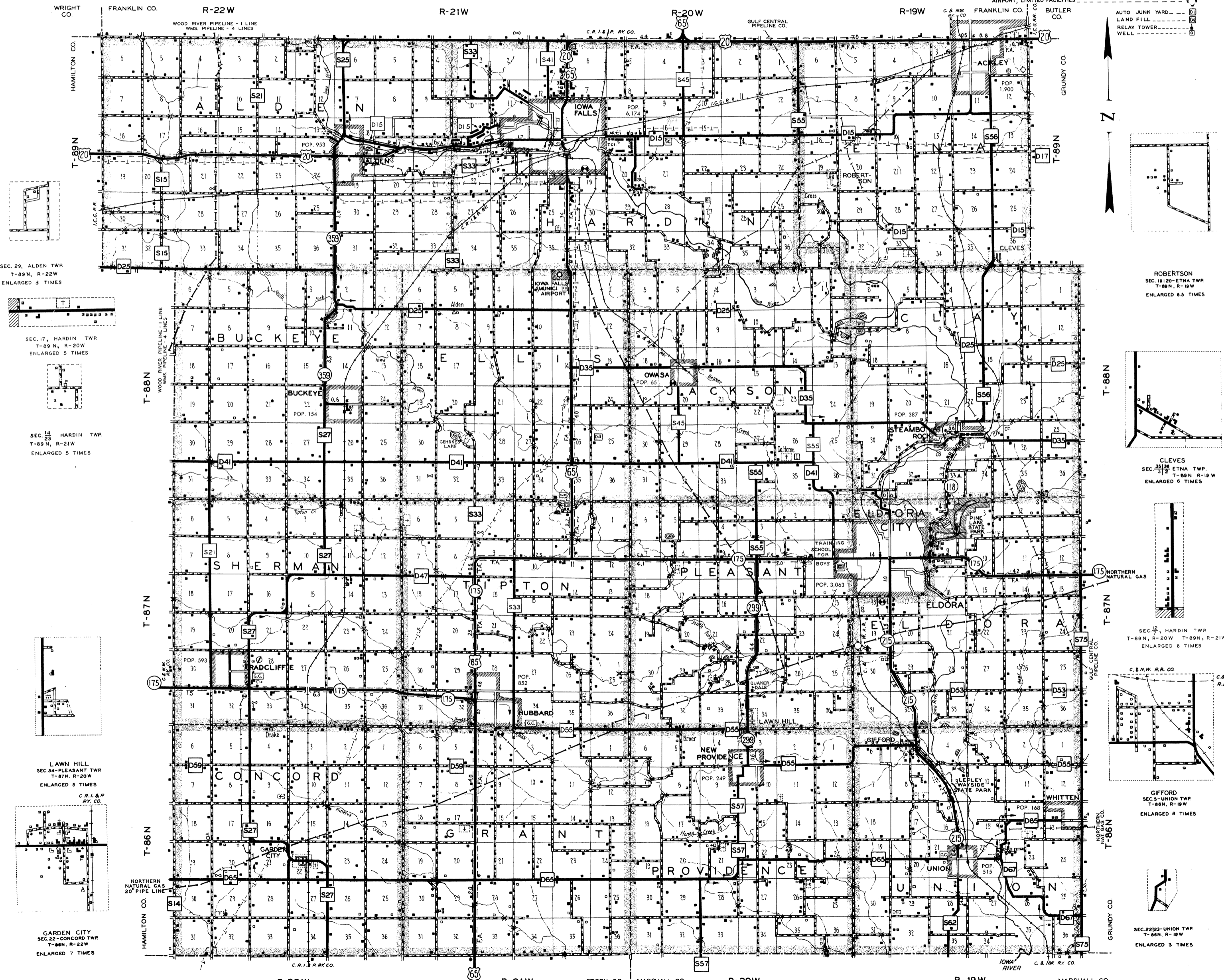

SEC. 29, ALDEN TWP T-89N, R-22W ENLARGED 5 TIMES

SEC. 17, HARDIN TWP T-89N, R-20W ENLARGED 5 TIMES

SEC. 25, HARDIN TWP T-89N, R-21W ENLARGED 5 TIMES

LAWN HILL SEC. 34, PLEASANT TWP T-87N, R-20W ENLARGED 5 TIMES

GARDEN CITY SEC. 22, CONCORD TWP T-86N, R-22W ENLARGED 7 TIMES

ROBERTSON SEC. 19, 20, ETNA TWP T-88N, R-19W ENLARGED 6.5 TIMES

CLEVES SEC. 35, 36, ETNA TWP T-88N, R-19W ENLARGED 6 TIMES

SEC. 12, HARDIN TWP T-89N, R-20W T-89N, R-21W ENLARGED 6 TIMES

C. & N.W. R.R. CO. C. & N.W. R.R. CO.

GIFFORD SEC. 5, UNION TWP T-86N, R-19W ENLARGED 6 TIMES

SEC. 22, 23, UNION TWP T-86N, R-19W ENLARGED 3 TIMES

