

2007 ANNUAL AVERAGE DAILY TRAFFIC

TRAFFIC FLOW MAP OF OSCEOLA COUNTY IOWA



Prepared By

Phone (515) 239-4282
In Cooperation With

United States Department of Transportation

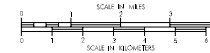

JANUARY 1, 2007



LEGEND

- DEEDED HIGHWAY
- PAVED ROAD
- MEANDERING ROAD
- GRAVEL ROAD
- EARTH ROAD
- UNPAVED GRAVEL ROAD

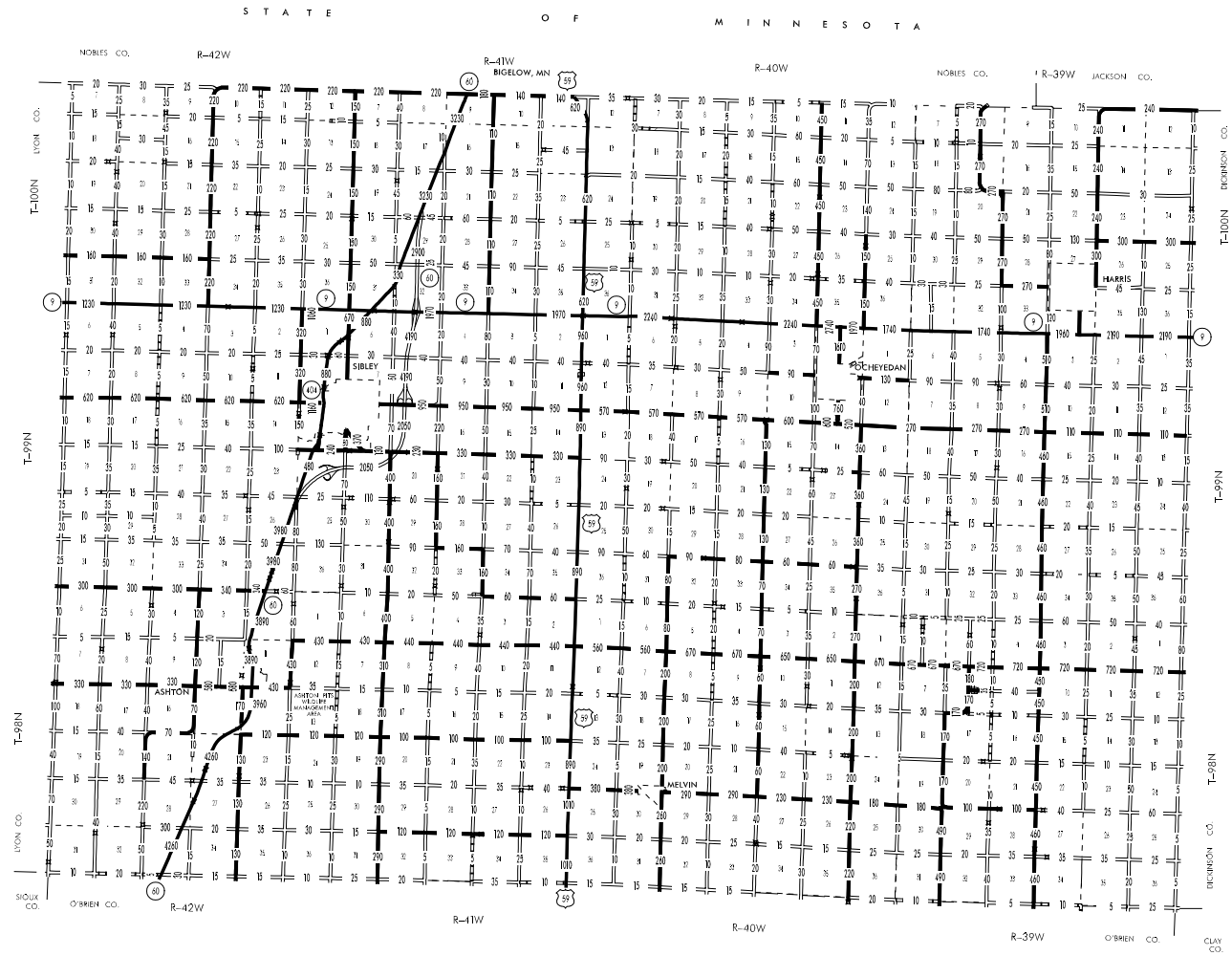

2007

